



US009493227B2

(12) **United States Patent**
Helou, Jr.

(10) **Patent No.:** **US 9,493,227 B2**
(45) **Date of Patent:** ***Nov. 15, 2016**

(54) **METHOD AND SYSTEM FOR LOADING AND UNLOADING CARGO ASSEMBLY ONTO AND FROM AN AIRCRAFT**

(71) Applicant: **Biosphere Aerospace, LLC**,
Carpinteria, CA (US)

(72) Inventor: **Elie Helou, Jr.**, Santa Barbara, CA
(US)

(73) Assignee: **Biosphere Aerospace, LLC**,
Carpinteria, CA (US)

(*) Notice: Subject to any disclaimer, the term of this patent is extended or adjusted under 35 U.S.C. 154(b) by 0 days.

This patent is subject to a terminal disclaimer.

(21) Appl. No.: **14/828,309**

(22) Filed: **Aug. 17, 2015**

(65) **Prior Publication Data**

US 2015/0353183 A1 Dec. 10, 2015

Related U.S. Application Data

(60) Continuation of application No. 14/259,818, filed on Apr. 23, 2014, now Pat. No. 9,108,720, which is a continuation of application No. 12/846,627, filed on Jul. 29, 2010, now Pat. No. 8,708,282, which is a continuation-in-part of application No. 12/833,868, filed on Jul. 9, 2010, now Pat. No. 8,608,110, which is a continuation-in-part of application No. 12/636,381, filed on Dec. 11, 2009, now abandoned, which is a division of application No. 11/782,850, filed on Jul. 25, 2007, now Pat. No. 7,699,267, which is a division of application No. 10/996,799, filed on Nov. 23, 2004, now Pat. No. 7,261,257.

(51) **Int. Cl.**
B64C 1/22 (2006.01)
B64C 1/00 (2006.01)
B64C 39/02 (2006.01)

(52) **U.S. Cl.**
CPC . **B64C 1/22** (2013.01); **B64C 1/00** (2013.01);
B64C 39/02 (2013.01)

(58) **Field of Classification Search**
CPC B64D 9/00; B64D 9/003; B64D 11/00;
B64C 1/20; B64C 1/22; B64C 1/00; B64C
7/00
See application file for complete search history.

(56) **References Cited**

U.S. PATENT DOCUMENTS

293,181 A * 2/1884 Lee B61D 19/002
49/201
2,053,969 A * 9/1936 Olds B60P 7/13
206/511
2,095,440 A * 10/1937 Hojnowski B64C 1/22
244/118.1

(Continued)

Primary Examiner — Benjamin P Lee

(74) *Attorney, Agent, or Firm* — Sheppard, Mullin,
Richter & Hampton LLP

(57) **ABSTRACT**

A system for loading and unloading a cargo assembly onto and from an aircraft. The system comprises an aircraft and a moveable platform. The aircraft comprises a forward fairing, an aft fairing, a spine disposed between the forward fairing and the aft fairing and a plurality of mounts coupled to the spine and configured to structurally engage the cargo container onto the spine. The aft fairing is movable between a fixed position for flight and an open position for at least loading and unloading of the cargo assembly. The aircraft is configured such that an unobstructed passageway is provided in an area underneath the spine during loading or unloading of the cargo assembly. An aft access is provided when the aft fairing is moved to the open position. The moveable platform is used to maneuver the cargo assembly for loading and unloading onto and from the spine, respectively.

21 Claims, 11 Drawing Sheets

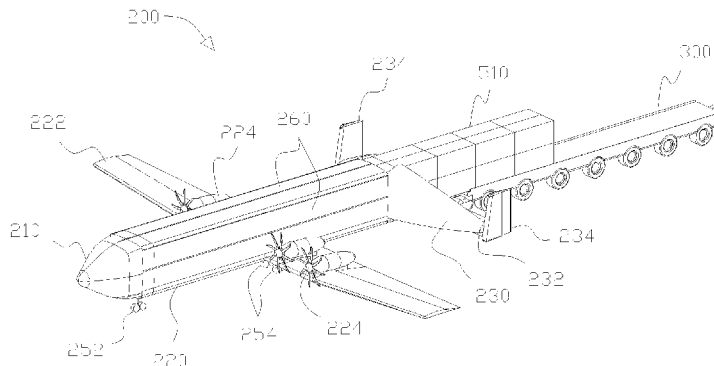

(56)

References Cited

U.S. PATENT DOCUMENTS

2,387,527	A *	10/1945	Nagamatsu	B64C 39/02 105/238.1	6,237,795	B1 *	5/2001	Buckley	B65D 19/44 206/386
2,388,380	A *	11/1945	Bathurst	B64C 1/22 220/1.5	6,308,131	B1 *	10/2001	Fox	B64D 9/00 177/136
2,407,724	A *	9/1946	Rasley	H02M 3/15 307/150	6,363,586	B1 *	4/2002	Neufingerl	B65D 88/005 220/1.5
2,407,774	A *	9/1946	Fowler	B64C 39/02 220/1.5	6,494,404	B1 *	12/2002	Meyer	B64C 39/02 244/118.1
2,425,499	A *	8/1947	Watter	B64C 3/00 244/118.3	6,554,225	B1 *	4/2003	Anast	B64C 1/18 105/422
2,425,972	A *	8/1947	Watter	B64C 1/22 244/118.3	6,557,800	B2 *	5/2003	Medina	B64D 9/00 193/35 R
2,446,441	A *	8/1948	Alanson	B64C 1/22 244/118.1	6,663,047	B1 *	12/2003	Arata	B64D 1/06 244/137.1
2,876,969	A *	3/1959	Tydon	B64C 1/22 244/118.3	6,817,579	B2 *	11/2004	van der Velden	B64C 37/02 244/118.5
2,931,681	A *	4/1960	Keller	B64F 1/31 14/71.5	7,000,765	B2 *	2/2006	Hase	B65D 90/0013 206/503
3,009,672	A *	11/1961	Tharratt	B64C 1/1415 244/137.1	7,003,374	B2 *	2/2006	Olin	B64C 1/20 244/118.1
3,028,130	A *	4/1962	Burton	B64D 9/00 244/118.2	7,195,200	B2 *	3/2007	Yamane	B64C 13/20 244/17.13
3,055,620	A *	9/1962	Weiland	B64C 1/1415 244/135 A	7,261,257	B2 *	8/2007	Helou, Jr.	B64C 1/00 244/118.1
3,147,942	A *	9/1964	Griffith	B64C 1/1415 160/202	7,344,109	B1 *	3/2008	Rezai	B64C 1/22 244/118.2
3,150,849	A *	9/1964	Graham	B64C 1/1415 244/100 R	7,534,082	B2 *	5/2009	Rawdon	B64D 9/00 410/72
3,209,929	A *	10/1965	Petersen	B60V 3/025 180/124	7,604,204	B2 *	10/2009	Jacobsen	B64D 9/00 244/118.1
3,289,981	A *	12/1966	Meyer	B61B 15/00 104/89	7,699,267	B2 *	4/2010	Helou, Jr.	B64C 1/00 244/1 R
3,368,838	A *	2/1968	Reich	B60P 7/132 24/287	7,721,988	B2 *	5/2010	Schiebel	B64C 39/024 244/17.11
3,381,921	A *	5/1968	McDonough	B64D 9/003 105/370	7,845,898	B2 *	12/2010	Rawdon	B64D 9/00 244/118.1
3,388,380	A *	6/1968	Coffin, Jr.	G06F 3/147 345/168	2003/0214143	A1 *	11/2003	Walker	B65D 88/022 294/81.53
3,419,164	A *	12/1968	O'Neill	B64F 1/31 180/125	2004/0135031	A1 *	7/2004	Stupakis	B64C 39/02 244/120
3,691,595	A *	9/1972	Backteman	B65D 90/0013 220/1.5	2004/0245378	A1 *	12/2004	Nonami	A63H 27/12 244/17.13
3,872,555	A *	3/1975	Link	B60P 7/132 220/1.5	2005/0247824	A1 *	11/2005	Allison, Sr.	B64D 11/00 244/137.2
3,966,285	A *	6/1976	Porch	B65D 7/24 220/4.28	2006/0022090	A1 *	2/2006	McCoskey	B64F 1/305 244/137.1
3,972,427	A *	8/1976	Stanley	B60P 1/02 244/137.1	2006/0038077	A1 *	2/2006	Olin	G06Q 10/08 244/137.1
4,039,163	A *	8/1977	Shorey	B64C 1/22 14/71.5	2006/0108477	A1 *	5/2006	Helou, Jr.	B64C 1/00 244/137.1
4,301,984	A *	11/1981	Olason	B64D 9/00 104/35	2007/0025832	A1 *	2/2007	Rawdon	B64D 9/00 414/401
4,379,533	A *	4/1983	Caldwell	B64C 39/02 244/118.1	2007/0125908	A1 *	6/2007	Eichholz	B64C 1/18 244/118.1
5,238,102	A *	8/1993	Langer	B65D 88/14 206/3	2009/0026314	A1 *	1/2009	Helou, Jr.	B64C 1/00 244/118.1
5,240,207	A *	8/1993	Eiband	G05D 1/0038 244/190	2009/0114773	A1 *	5/2009	Helou, Jr.	B64C 1/061 244/137.1
5,816,425	A *	10/1998	Keip	B65D 11/1873 220/4.31	2010/0181416	A1 *	7/2010	Sakamoto	B64C 39/024 244/17.21
5,975,464	A *	11/1999	Rutan	B64C 39/02 244/118.2	2010/0252682	A1 *	10/2010	Pahl	B64C 1/22 244/129.5
6,070,460	A *	6/2000	Leslie	G01J 5/0014 73/170.07	2010/0276538	A1 *	11/2010	Helou, Jr.	B64C 39/02 244/118.1

* cited by examiner

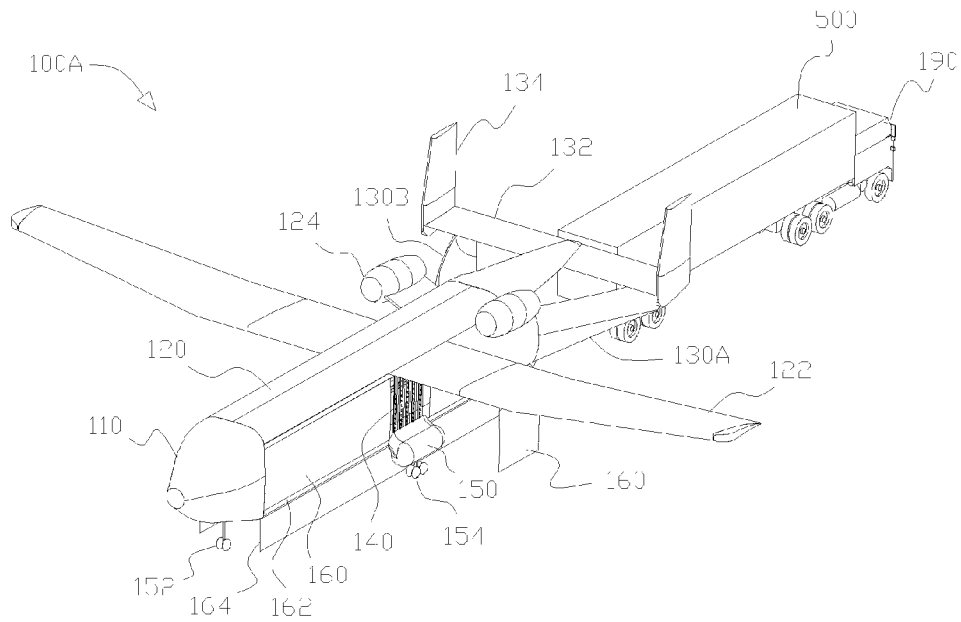

Figure 1

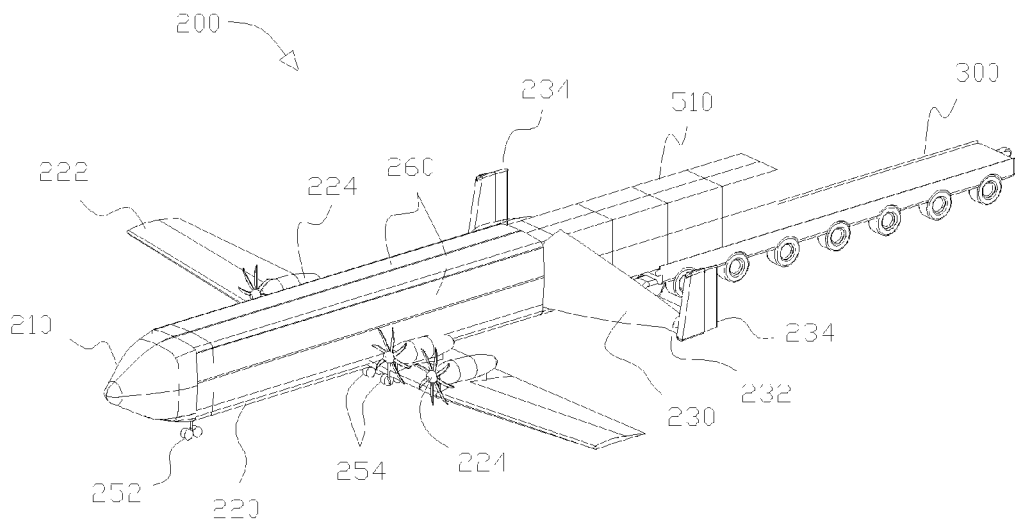

Figure 2

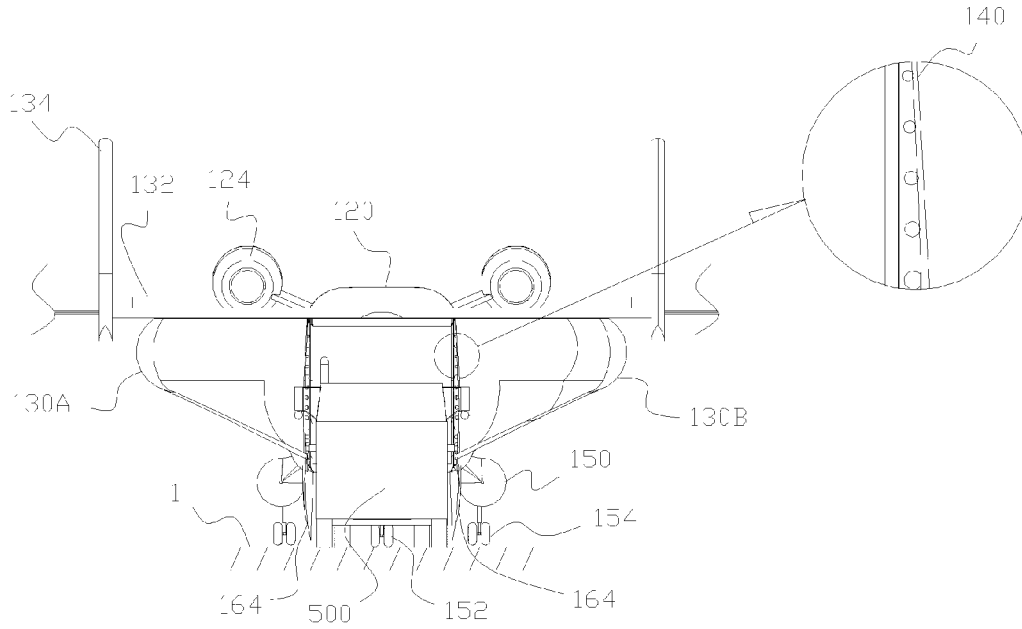

Figure 3A

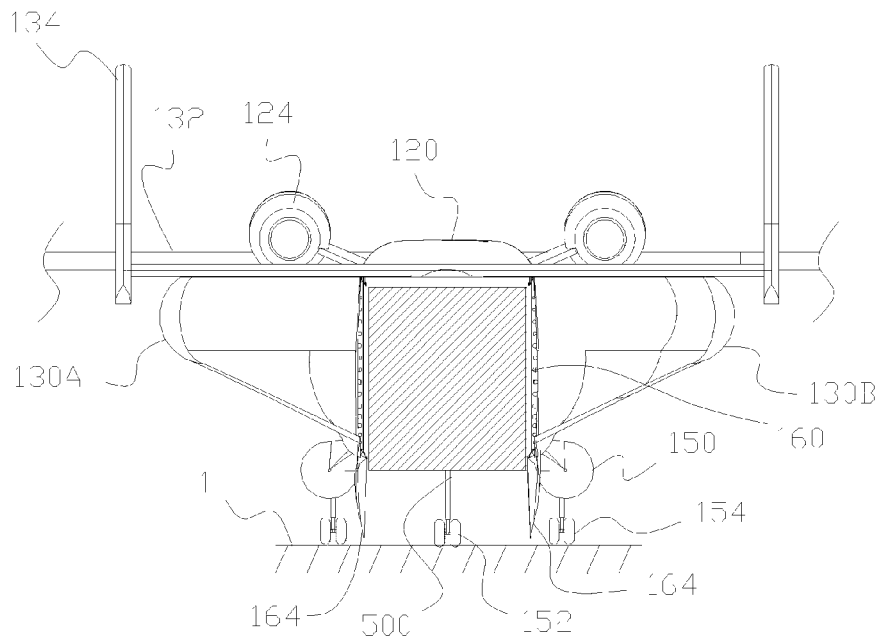

Figure 3B

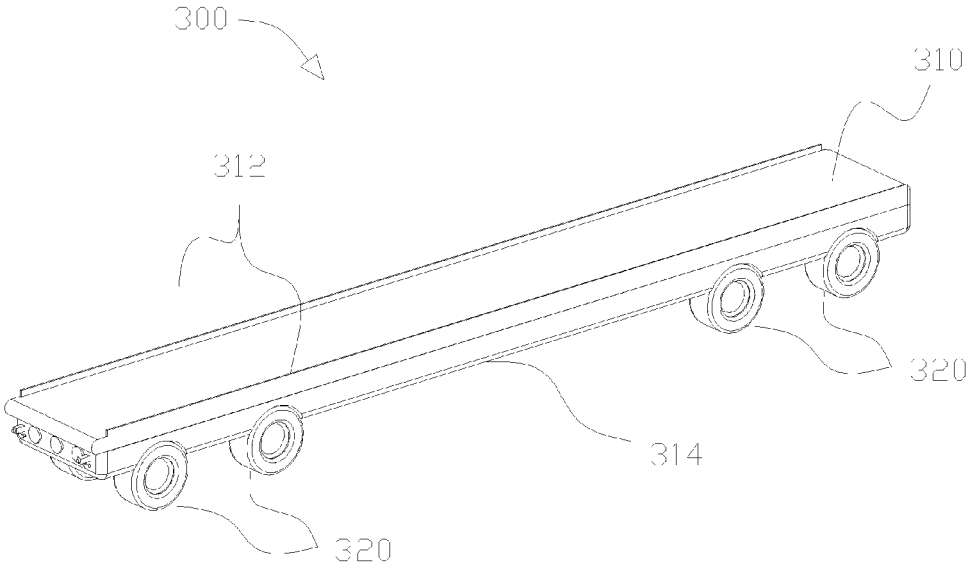

Figure 4A

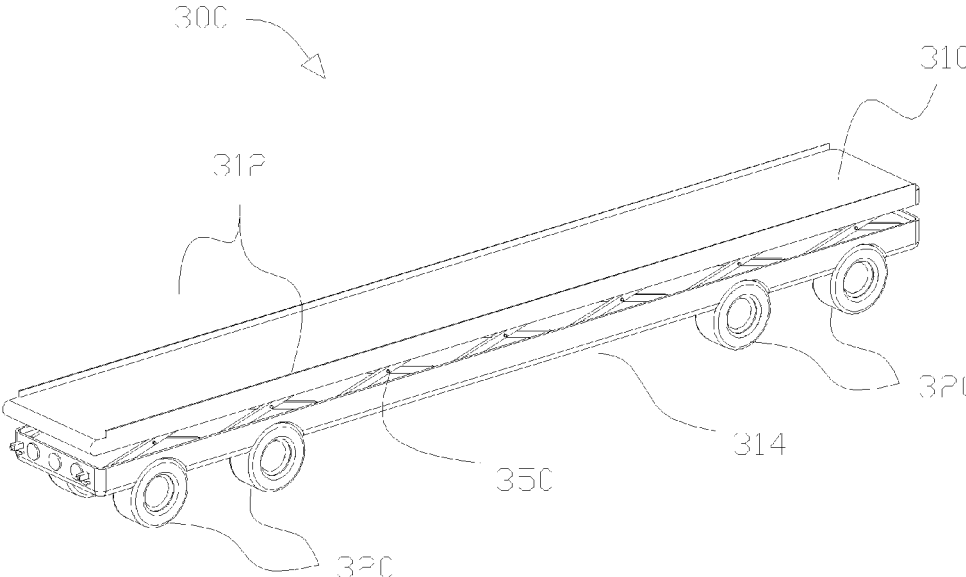

Figure 4B

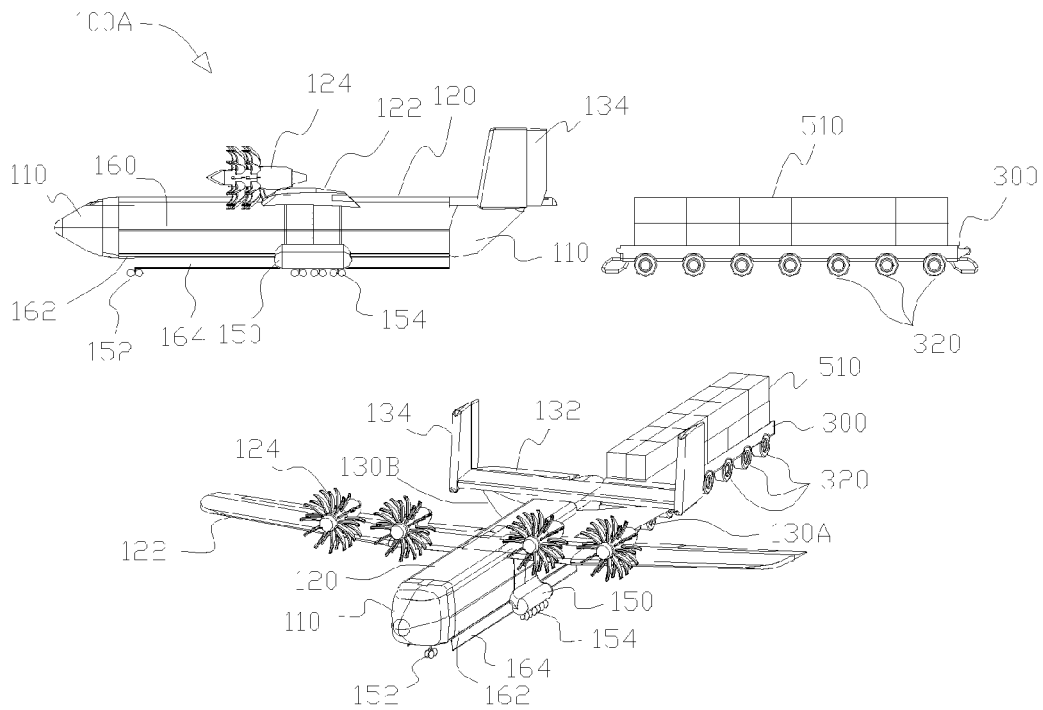

Figure 5A

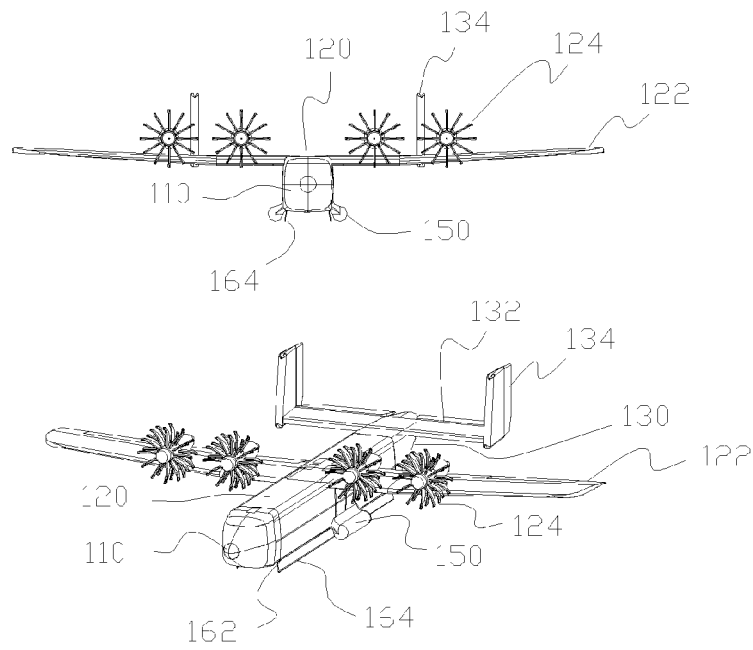

Figure 5B

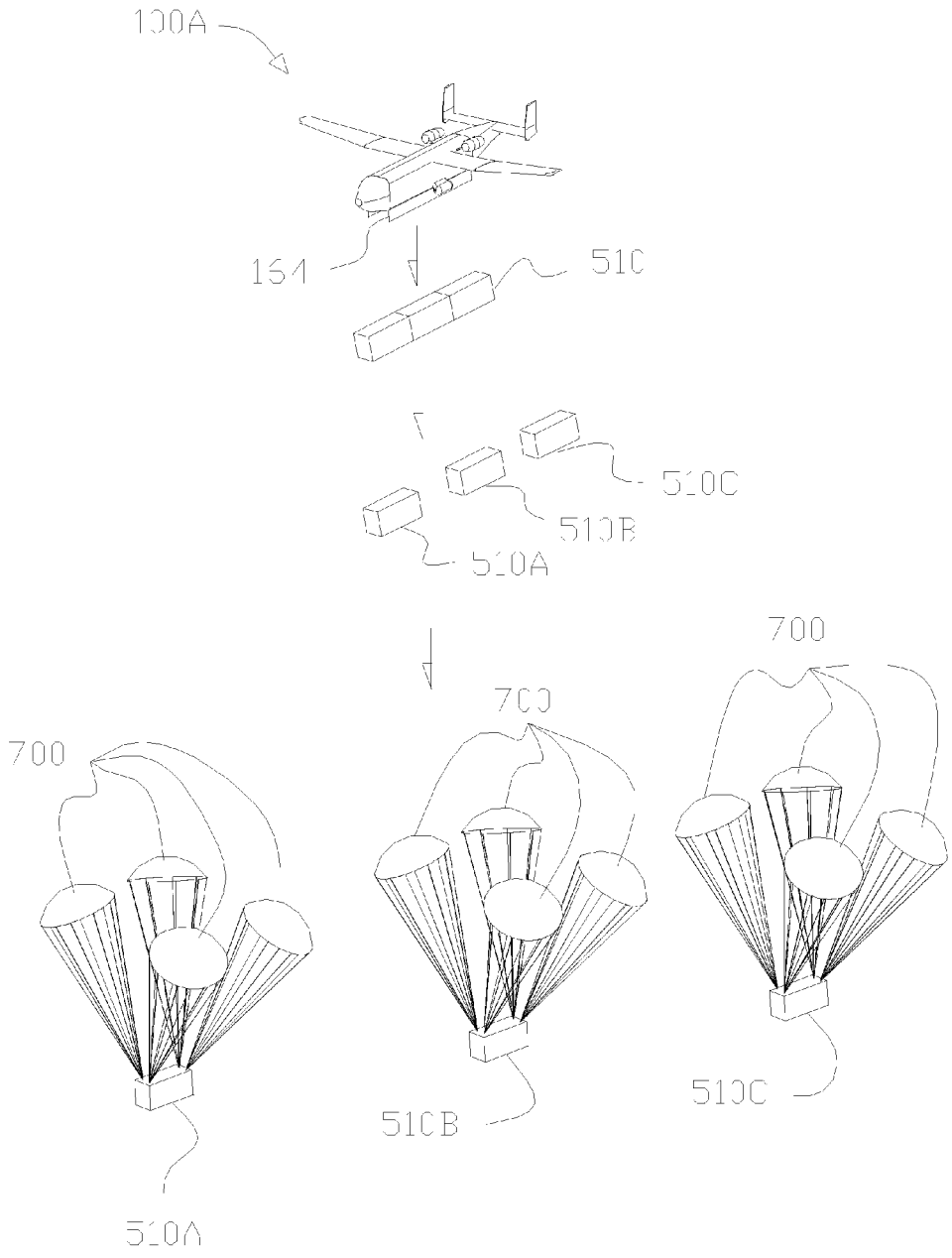

Figure 5C

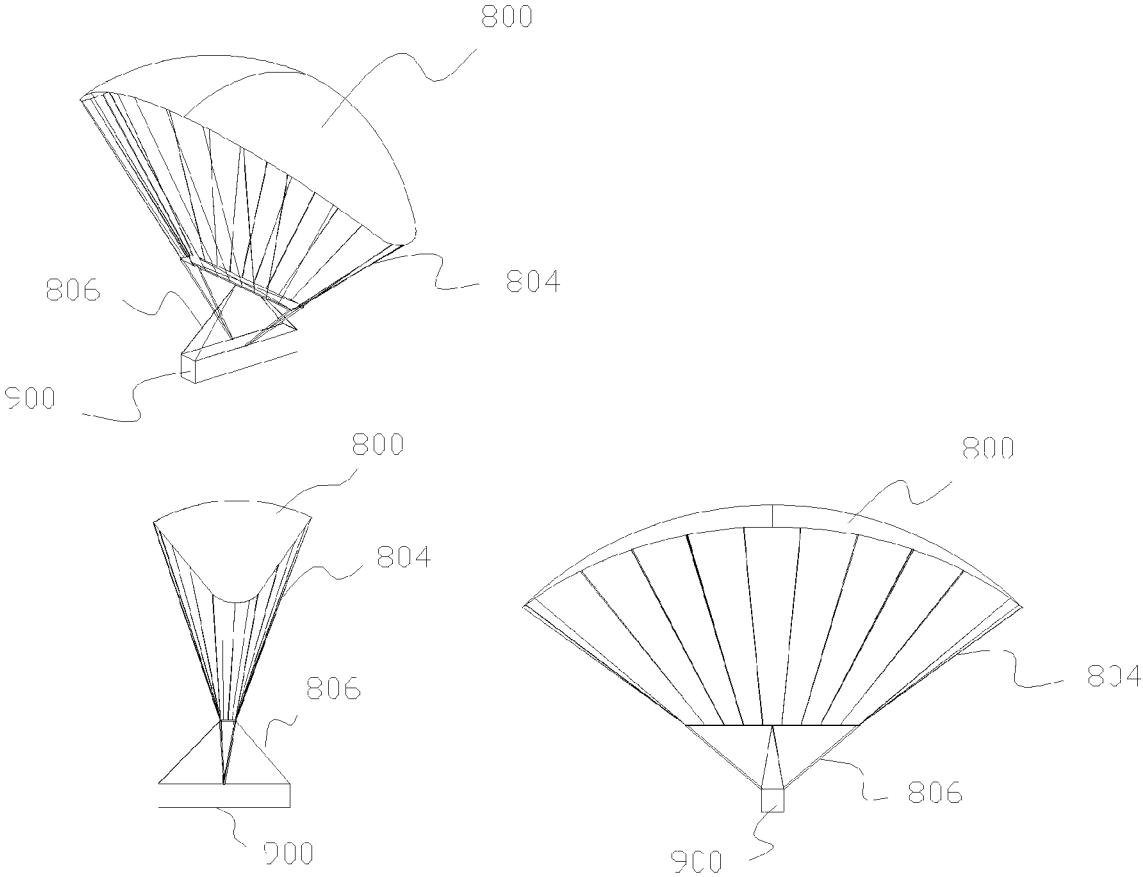

Figure 6

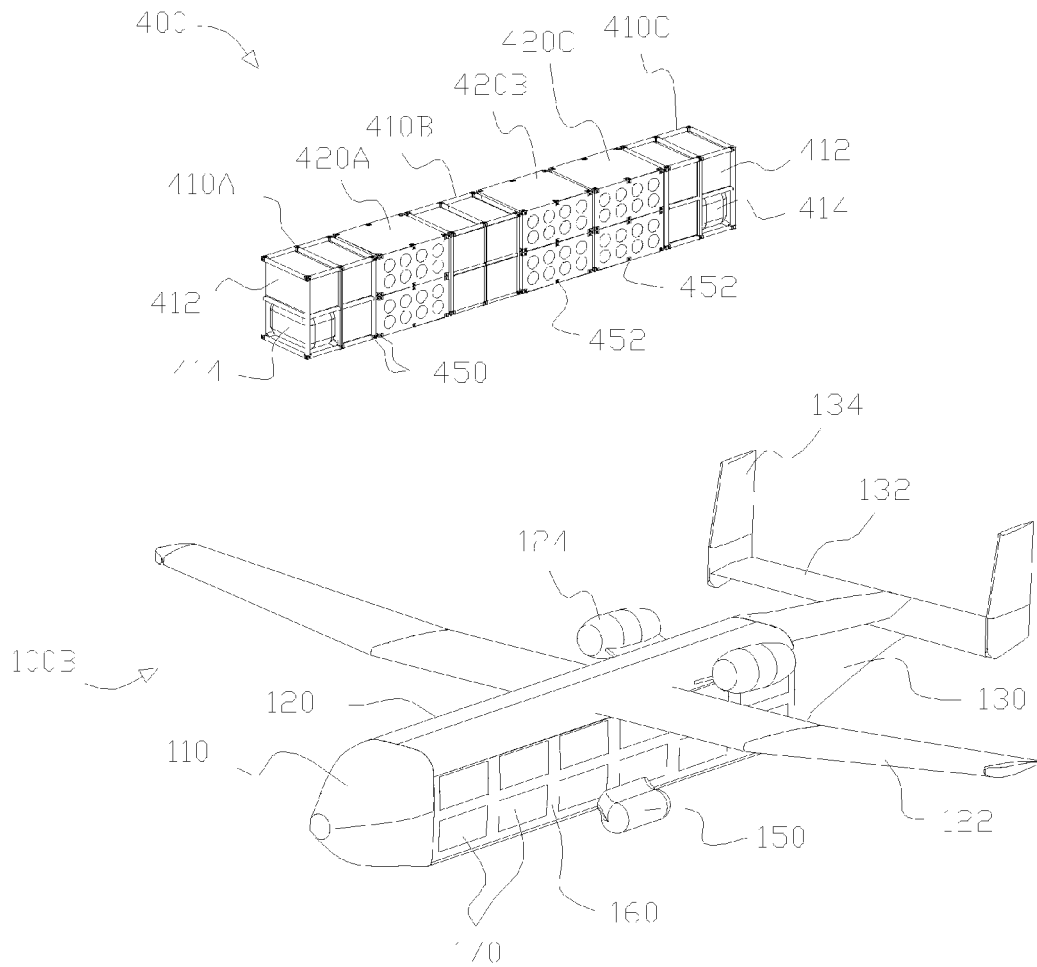

Figure 7

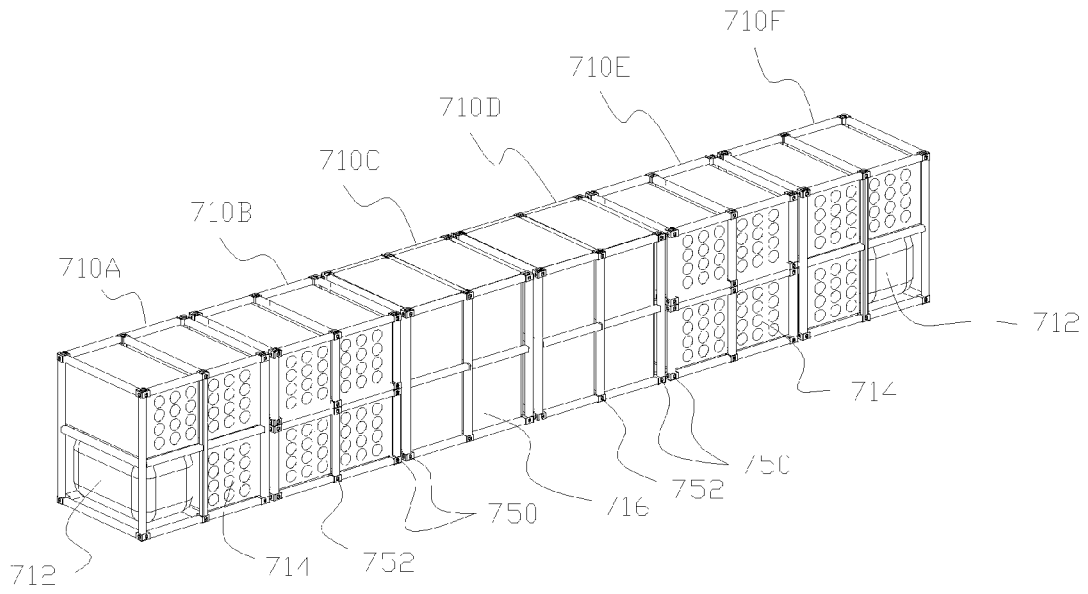

Figure 8A

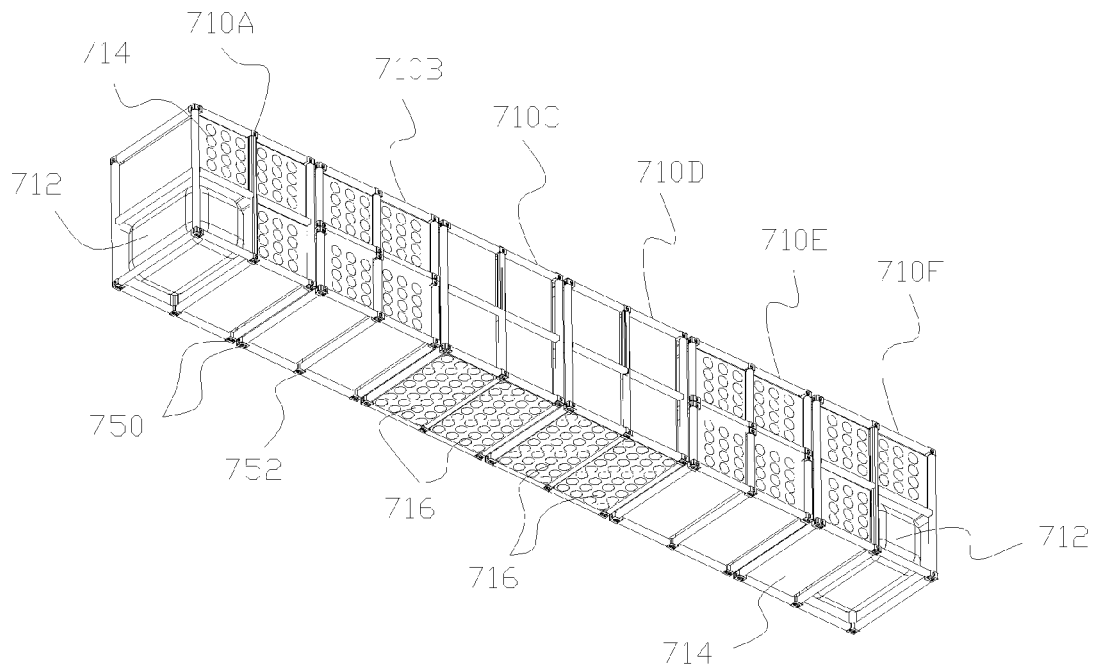

Figure 8B

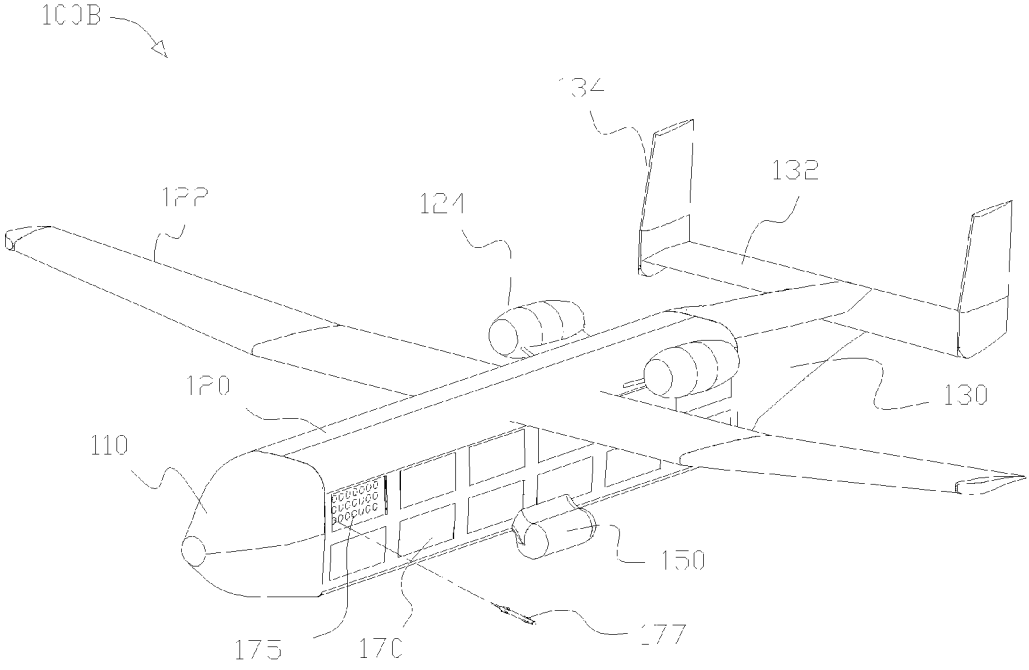

Figure 9

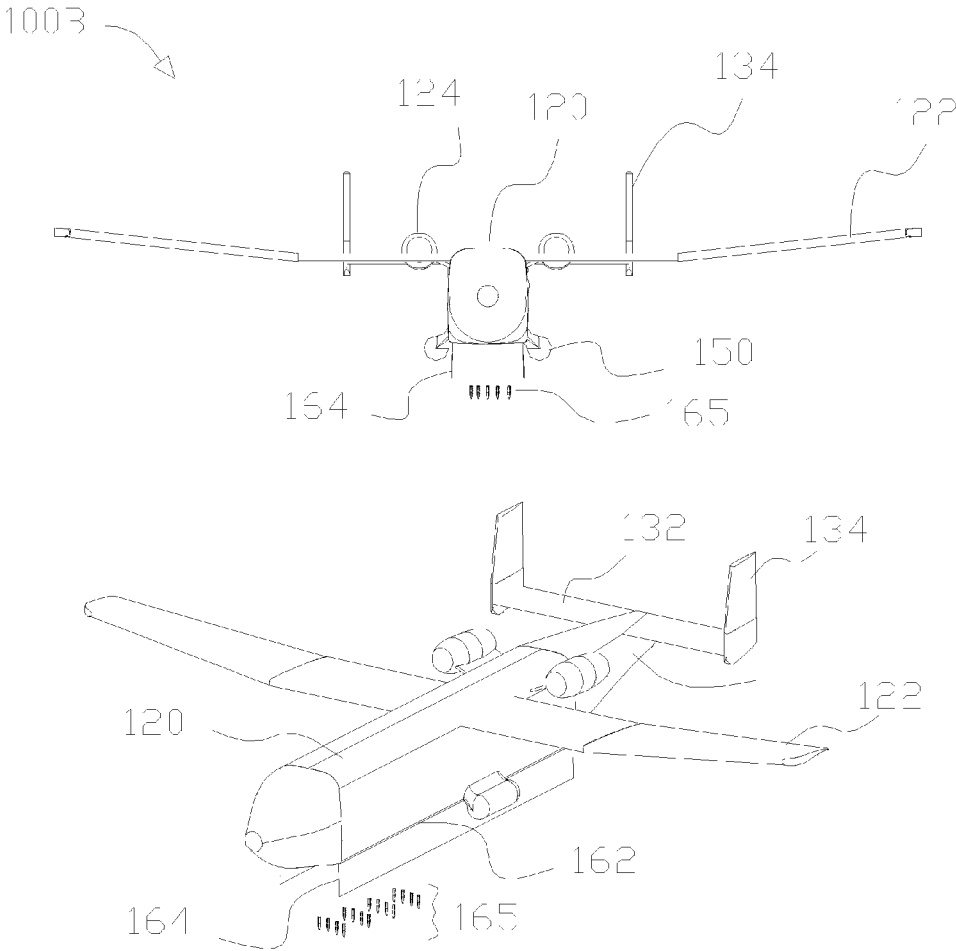

Figure 10

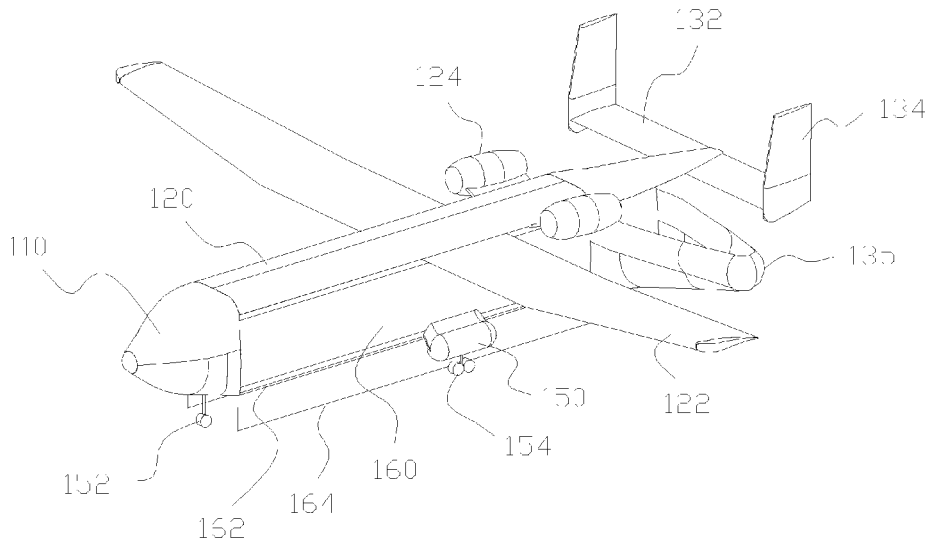

Figure 11A

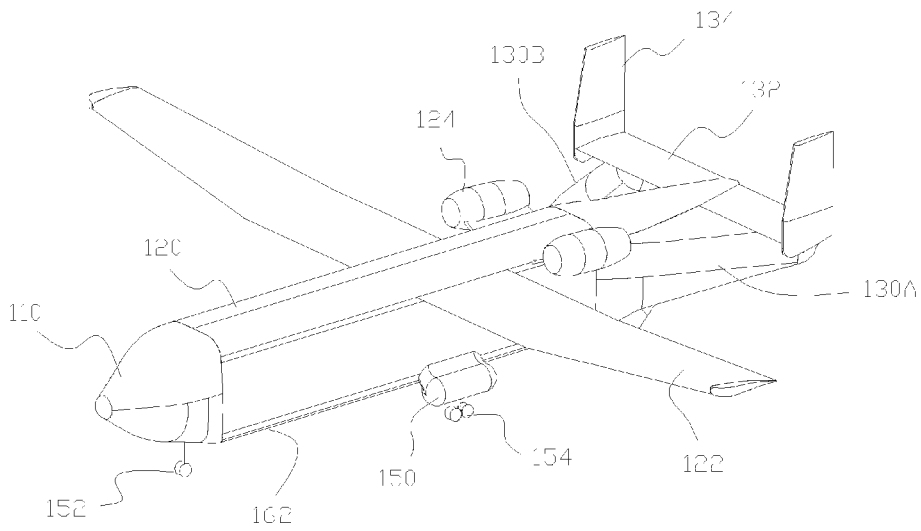

Figure 11B

**METHOD AND SYSTEM FOR LOADING
AND UNLOADING CARGO ASSEMBLY
ONTO AND FROM AN AIRCRAFT**

CROSS-REFERENCE TO RELATED
APPLICATIONS

This application is a continuation of U.S. patent application, Ser. No. 14,259,818, filed on Apr. 23, 2014, which is a continuation of U.S. patent application, Ser. No. 12/846,627, filed on Jul. 29, 2010, now U.S. Pat. No. 8,708,282, issued on Apr. 29, 2014, which is a continuation-in-part of U.S. patent application, Ser. No. 12/833,868, filed on Jul. 9, 2010, now U.S. Pat. No. 8,608,110, issued on Dec. 17, 2013, which is a continuation-in-part of U.S. patent application, Ser. No. 12/636,381 filed on Dec. 11, 2009, now abandoned, which is a divisional application of U.S. patent application, Ser. No. 11/782,850, filed Jul. 25, 2007, now U.S. Pat. No. 7,699,267, issued on Apr. 20, 2010, which is a divisional application of U.S. patent application, Ser. No. 10/996,799, filed Nov. 23, 2004, now U.S. Pat. No. 7,261,257, issued on Aug. 28, 2007. The disclosures of each of these references are incorporated herein by reference in each of their entireties.

FIELD OF THE INVENTION

The present invention relates to a cargo aircraft system and, more particularly, to a cargo aircraft system that is designed to transport modular cargo units of various configurations and sizes.

BACKGROUND

The basic unit for transporting goods has been the truck. Being the basic unit, the truck has defined limitations on intermodal containers that can typically be transported by ships, trains and trucks. However, airplanes have generally been excluded from participation in transportation of intermodal and many other types of cargo. This is due to the limitations placed by the design and construction of cargo airplanes.

The design and construction of most civilian cargo aircraft are based on that of passenger airplanes. The basic structure is a monocoque-based fuselage which is substantially cylindrical in shape. Monocoque-based structures support the structural load of an aircraft by a unitary structural body, as opposed to heavier internal frames or trusses. The unibody construction of the monocoque-based aircraft generally lack sufficient structure to adequately or efficiently support and distribute concentrated cargo loads across the aircraft fuselage and to the wings.

Additionally, the cylindrically-shaped fuselage imposes additional restrictions on cargo size and dimensions. Thus, cargo having irregular or unusually large dimensions are generally unsuited for air transport via today's cargo aircraft. Moreover, as most cargo units are substantially rectangular in shape, loading such cargo units into a cylindrical fuselage results in a significant amount of wasted dead space.

SUMMARY

The cargo aircraft systems disclosed herein comprise a spine structure onto which a cargo assembly may be mounted. The spine structure replaces the cylindrically-shaped monocoque-based fuselages of today's aircraft and has sufficient structure, in combination with the cargo

assembly, to distribute concentrated cargo loads along its length and to the wings. The cargo assembly is an integrated and unitary structure formed from one or a plurality of cargo units coupled together. The cargo unit may be a modular frame unit or a modular container unit and the resulting cargo assembly may be any one or a combination of modular frame and container units. The cargo assembly is structurally integrated with the spine to form part of the aircraft structure such that the aircraft is able to withstand torsional and bending loads experienced during flight. Thus, the cargo assembly augments the structure of the spine, which itself would not be able to sustain the torsional and bending loads of the aircraft when the spine is loaded with the cargo assembly. Moreover, because the cargo aircraft eliminates the need for additional structure to support the load of the cargo assembly, a significant reduction in the weight of the cargo aircraft is realized. This, in turn, results in greater fuel efficiency and decreased cost of operation.

In one embodiment, an aircraft for transporting a cargo assembly is disclosed. The aircraft comprises a forward fairing, an aft fairing and a spine disposed between the forward fairing and the aft fairing. The aft fairing is movable between a fixed position for flight and an open position for at least loading and unloading of the cargo assembly. The aircraft is configured such that an unobstructed passageway is provided between the ground surface and the spine during loading or unloading of the cargo assembly onto or from the spine, respectively. An aft access to the unobstructed passageway and the spine is provided when the aft fairing is moved to the open position.

In accordance with a first aspect, the aft fairing is removed from the aircraft to provide the aft access to the unobstructed passageway and the spine when the aft fairing is in the open position.

In accordance with a second aspect, the aft fairing is pivotally moved to provide the aft access to the unobstructed passageway and the spine when the aft fairing is in the open position.

In accordance with a third aspect, the aircraft further comprises lower fairing doors pivotally coupled to lateral sub-structures coupled to the forward fairing and the aft fairing.

In accordance with a fourth aspect, the aircraft further comprises side fairing panels disposed between the forward fairing and the aft fairing.

In accordance with a fifth aspect, the side fairing panels further comprise one or more subpanels, the one or more subpanels being retractable to expose a portion of the cargo assembly. The subpanels may be retracted to expose the portion of the cargo assembly while the aircraft is in flight.

In accordance with a sixth aspect, the aircraft further comprises a plurality of mounts coupled to the spine, the plurality of mounts configured to structurally engage the cargo assembly onto the spine. The plurality of mounts may be actuated between an engage and a release position, wherein in the engage position, the mounts structurally engage the cargo assembly to the spine and wherein in the release position, the mounts disengage and release the cargo assembly from the spine. The plurality of mounts may be actuated in a release position to disengage and release the cargo assembly from the spine while the aircraft is in flight.

In accordance with a seventh aspect, the aft fairing comprises two halves pivotally coupled to corresponding sides of the aircraft. The two halves of the aft fairing are pivotally actuated in the open position to increase drag during landing of the aircraft.

3

In accordance with an eighth aspect, the aircraft further comprises wings coupled to the spine. The aircraft may further comprise landing gear and supports coupling the landing gear to either one or both of the spine or the wings.

In another embodiment, a system for loading and unloading a cargo assembly onto an aircraft is disclosed. The system comprises an aircraft and a moveable platform. The aircraft comprises a forward fairing, an aft fairing and a spine disposed between the forward fairing and the aft fairing. A plurality of mounts are configured to structurally engage the cargo container onto the spine. The aircraft is configured such that an unobstructed passageway underneath the spine is provided during loading or unloading of the cargo assembly onto or from the spine. The moveable platform is configured for maneuvering the cargo assembly to and from the spine.

In accordance with a first aspect the aft fairing is movable between a fixed position for flight and an open position and wherein an aft access to the unobstructed passageway and the spine is provided when the aft fairing is in the open position.

In accordance with a second aspect, the moveable platform maneuvers the cargo assembly to and from the spine via the aft access and the unobstructed passageway.

In accordance with a third aspect, the movable platform further comprises sensors for determining a location of the movable platform relative to the spine. The moveable platform may be configured to lift the cargo assembly onto the spine. The aircraft spine and the movable platform may each comprise means for determining a loading position of the movable platform relative to the spine prior to lifting the cargo assembly onto the spine for mounting thereon.

Other objects, features and advantages of the present invention will become apparent to those skilled in the art from the following detailed description.

BRIEF DESCRIPTION OF THE DRAWINGS

Illustrative embodiments of the present invention are described herein with reference to the accompanying drawings, in which:

FIG. 1 is a perspective view of an embodiment of the cargo aircraft system showing the aft loading of the cargo assembly onto an upper spine aircraft.

FIG. 2 is a perspective view of another embodiment of the cargo aircraft system showing the aft loading of the cargo assembly onto a lower spine aircraft.

FIGS. 3A and 3B illustrate the loading of the cargo assembly onto the upper spine.

FIGS. 4A and 4B are perspective views of an embodiment of the moveable platform used for loading the cargo assembly onto the aircraft.

FIGS. 5A through 5C illustrate an exemplary sequence of loading, transporting and unloading of the cargo assembly from the aircraft.

FIG. 6 is an embodiment of a cargo assembly having a deployed parachute.

FIG. 7 is an embodiment of a cargo assembly and an aircraft having retractable side fairings to expose select portions of the cargo assembly.

FIGS. 8A and 8B are top and bottom perspective views, respectively, of an embodiment of a cargo assembly.

FIG. 9 illustrates the lateral deployment of a missile from an embodiment of the aircraft having retractable side fairings.

4

FIG. 10 illustrates the drop deployment of missiles or bombs from an embodiment of the aircraft having open lower fairing doors.

FIGS. 11A and 11B show different embodiments of providing an aft access to the aircraft spine.

Like numerals refer to like parts throughout the several views of the drawings.

DETAILED DESCRIPTION OF THE PREFERRED EMBODIMENTS

FIG. 1 illustrates an embodiment of a cargo aircraft system. The cargo aircraft system is depicted as comprising an aircraft 100A and a cargo transporter 190, such as a truck or a moveable platform, comprising a cargo assembly 500. Embodiments of the basic structure of a cargo aircraft are also described in U.S. Pat. No. 7,261,257, issued Aug. 28, 2007, and U.S. patent application Ser. No. 12/833,868 filed on Jul. 9, 2010, the entire contents of which are incorporated herein by reference.

Generally, the cargo aircraft 100A comprises a forward fairing 110, an aft fairing 130A, 130B, and an empennage having laterally extending horizontal stabilizers 132 and twin vertical stabilizers 134. An upper spine 120 is provided between the forward fairing 110 and aft fairing 130A, 130B. A plurality of mounts (not shown) is disposed at various intervals along the upper spine 120 to structurally engage the cargo assembly 500 at various attachment points. A depiction of the mounts and the manner in which the cargo assembly is coupled onto the upper spine via the mounts, is further described in U.S. Pat. No. 7,261,257 and co-pending U.S. patent application Ser. No. 12/833,868.

The upper spine 120 is understood as comprising one or more layers of interconnected spars and bulkheads/ribs to which mounts are attached, as described in co-pending U.S. patent application Ser. No. 12/833,868. It is understood that the number of layers of interconnected spars and bulkheads/ribs may be provided as required by specific weight regimes. The upper spine 120 is designed to be as light as possible. As such, the spine structure is capable of supporting takeoff loads, flight loads and landing loads of the aircraft when free of cargo. However, when the cargo assembly 500 is mounted onto the spine, the spine, by itself, is not required to fully sustain bending and torsional loads in flight, and landing and takeoff loads. The additional rigidity required is supplied by the cargo assembly 500. The cargo assembly 500 augments the spine and aircraft structure so as to support these loads when it is structurally integrated to the spine. To this end, the individual units comprising the cargo assembly are constructed with sufficient structure and rigidity and are securely mounted to the spine such that bending and torsional forces experienced by the spine structure are imposed upon the cargo assembly.

The simplicity of the spine structure furthermore permits it to be configured in any variety of widths and weight capacities. Thus, for example, the spine may be configured to support extra large cargo loads which cannot be transported within standard intermodal containers by simply increasing the width and the number of layers of interconnected bulkheads and spars to an extent necessary to accommodate such extra large cargo loads. Thus, the spine permits greater flexibility with respect to the dimensions of the cargo assembly than would be realized by an aircraft with the standard monocoque-based cylindrical fuselage. Moreover, the structural features of the spine allow for the cargo load to be more efficiently distributed along the spine and also to the wings.

Wings **122** are structurally associated with the upper spine **120**. Wings **122** may optionally contain fuel tanks (not shown). Forward landing gear **152** may be provided underneath the forward fairing **110** and lateral landing gears **154** may be provided on both sides of the spine **120**. The lateral landing gears **154** extends from respective pods **150** for landing and take-off and retracts into the pods **150** during flight. Supports **140** may couple the pods **150** to the spine **120** as shown in FIGS. **1** and **3A-B** or, alternatively, to the wings **122** (not shown). The supports **140** must be constructed of sufficient structure, as they experience compression load from the lateral landing gear **154** during landing and take-off. As such, they may be constructed in a manner similar to the spine described above, based on the anticipated load of the aircraft and the cargo assembly. Engines **124** are shown in the embodiment of FIG. **1** to be laterally mounted to the spine **120**. It is understood that the engines **124** may also be mounted to the wings **122**.

Side fairings **160** may be provided on both sides of the aircraft to reduce the drag of the aircraft in flight. Lower fairing doors **164** may also be pivotally coupled to the sub-structure **162** extending between the forward fairing **110** and the aft fairing **130A, B**. The sub-structure **162** may be further supported along its length via straps extending vertically from the spine **120**. The lower fairing doors **164** are pivotally opened during loading and unloading of the cargo assembly **500** onto and from the aircraft **100A**. The side fairings **160** and the lower fairing doors **164** are preferably made of a composite light weight material and the primary function of the aerodynamic fairings is to reduce drag. In a particularly preferred embodiment, the side fairings **160** and the lower fairing doors **164** are of a light weight structure and do not provide substantial, if any, support or rigidity to the aircraft in flight.

The aft fairing in FIGS. **1, 3A, 3B,** and **11B** is depicted as having two halves **130A, 130B**, which are each pivotally coupled to corresponding sides of the aircraft. Alternatively, as depicted in FIGS. **2** and **11A**, the entire aft fairing **135** may be provided as a single integral unit that is pivotally coupled to one side of the aircraft. One advantage of having the aft fairings in two halves **130A, 130B** is that the two halves may be pivotally actuated in the open position during loading and unloading of the cargo assembly and also during landing operations to increase drag and the reduce landing roll out.

FIG. **2** illustrates another embodiment of the cargo aircraft system. The cargo aircraft system is depicted as comprising an aircraft **200** and a moveable platform **300** comprising a cargo assembly **510**. The cargo aircraft **200** comprises a forward fairing **210**, an aft fairing **230**, and an empennage having laterally extending horizontal stabilizers **232** and twin vertical stabilizers **234**. Unlike the aircraft depicted in FIG. **1**, the cargo aircraft **200** comprises a lower spine **220** between the forward fairing **210** and the aft fairing **230**. A plurality of mounts (not shown) is similarly disposed at various intervals along the lower spine **220**. The plurality of mounts may further be retracted beneath the surface of the lower spine **220** to facilitate loading of the cargo assembly **510**. Once the cargo assembly **510** is loaded onto the lower spine **220**, the plurality of mounts may be actuated to structurally engage the cargo assembly **510** at attachment points provided on the cargo assembly **510**. A depiction of the mounts and the manner in which the cargo assembly is coupled onto the lower spine via the mounts, is further described in U.S. Pat. No. 7,261,257 and co-pending U.S. patent application Ser. No. 12/833,868.

Wings **222** are structurally associated with the lower spine **220**. Wings **222** may optionally contain fuel tanks (not shown). Forward landing gear **252** may be provided underneath the forward fairing **210** and lateral landing gears **254** may be provided underneath the spine **220** or the wings **222**. Engines **224** are shown in the embodiment of FIG. **1** to be mounted to the wings **222**.

Aerodynamic fairings **260** may be provided to enclose the cargo assembly **510** mounted onto the lower spine **220**. Again, the aerodynamic fairings **260** are preferably made of a composite light weight material and the primary function of the aerodynamic fairings is to reduce drag. In a particularly preferred embodiment, the aerodynamic fairings **260** are of a lightweight structure and thus do not provide substantial, if any, support or rigidity to the aircraft in flight. As explained above, the aft fairing **230** is a single integral unit that is pivotally coupled to one side of the aircraft **200**.

FIGS. **3A-3B** show the loading sequence of the cargo assembly **500** onto the upper spine **120** of the aircraft depicted in FIG. **1**. As shown in FIG. **3A**, the two halves of the aft fairing **130A, 130B** are pivotally coupled to corresponding sides of the aircraft and are opened to permit an aft access to the spine. The aircraft is further configured such that an unobstructed passageway is provided underneath the spine when the lower fairing doors **164** are pivotally opened. Because there are no intervening aircraft structures between the ground surface **1** and the spine **120**, a vehicle or a moveable platform **300** may be maneuvered from the aft access to a position directly underneath the spine **120**. Once the moveable platform **300** is in the appropriate position underneath the spine **120**, the cargo assembly **500** is vertically elevated toward the spine **120** for mounting.

As shown in FIGS. **4A-B**, the moveable platform **300** comprises a surface **310** upon which the cargo assembly may be supported and a pair of longitudinal side flanges **312** to restrain the cargo assembly on the surface **310**. The surface **310** is coupled to a lift mechanism **350** which, in turn, is coupled to a frame **314** supported by a plurality of wheels **320**. The moveable platform **300** is movable in both a horizontal and vertical direction, either manually or remotely. The moveable platform **300** may further comprise a mechanism to facilitate the proper positioning of the cargo assembly **500** relative to the spine **120** prior to lifting the cargo assembly **500** onto the spine **120**. This may be done via sensors which track the position of the cargo assembly **500** relative to the spine.

The absence of intervening aircraft structures when the fairing doors **164** are pivotally opened also permit the aircraft **100A** to deliver the cargo assembly **500** loaded onto the upper spine **120** during flight. This may be accomplished by disengaging the cargo assembly **500** from the upper spine **120**, and thereby allowing the cargo assembly **500** to drop to a desired location.

FIG. **5A-C** illustrate an exemplary sequence of loading, transporting and unloading of the cargo assembly from the aircraft **100A**. As shown in FIG. **5A**, the aircraft **100A** is supported on the ground by the forward landing gear **152** and the lateral landing gears **154** extended from the respective pods **150** on either sides of the spine **120**. It is understood that the lateral landing gears **154** and the pods are angled away from the spine **120** so as to provide a clear passageway between the spine **120** and the ground for the movement of cargo. This is more clearly shown in FIGS. **3A-B**, in which the arrangement of the supports **140** and the landing pods **150** and the lateral landing gear **154** permit the unobstructed passageway between the spine **120** and the ground.

FIG. 5A depicts the aircraft 100A in which the aft fairings 130A, 130B are pivotally opened to permit an aft access to the spine 120. A moveable platform 300 comprising a plurality of wheels 320 is provided to transport the cargo assembly 510 through the aft access. Once the cargo assembly 510 is at an appropriate position underneath the spine 120, the moveable platform 300 raises the cargo assembly 510 onto the spine 120 onto which it is attached via mounts. The aircraft 100A is ready for flight after the cargo assembly 510 is structurally integrated onto the spine 120 via the mounts and the aft fairings 130A, 130B are pivotally secured in the dosed position.

FIG. 5B shows the aircraft 100A in flight with its forward landing gear 152 and the lateral landing gear 154 retracted. The aft fairing doors 164 are opened to permit the dropping of the cargo assembly 510 once the aircraft reaches a desired location for delivery. It is understood that the cargo assembly 510 is comprised of modular units of structural frame assemblies, structural container assemblies, or combinations thereof. The modular nature of the frames and containers allows great flexibility in creating a final cargo assembly that is capable of accommodating various types, sizes, dimensions and weights of cargo. Once these modular units are structurally coupled together to form a cargo assembly, they may be coupled to the aircraft spine to provide an integrated structure that is capable of taking on and distributing bending and torsional loads to the spine and the wings of the aircraft.

FIG. 5C illustrates an exemplary drop sequence in which the cargo assembly 510 is initially disengaged and dropped from the aircraft spine 120 as a single unit. In a preferred embodiment, the entire payload of the cargo assembly is disengaged at the same time so as to ensure that the weight distribution of the aircraft remains within an acceptable center of gravity. To that end, the mounts coupling the cargo assembly to the upper spine 120 may further comprise explosives which detonate at the same time to ensure complete and substantially simultaneous disengagement of the mounts.

The modular units 510A, B, C comprising the cargo assembly 510 may subsequently be disengaged from one another a pre-determined time after the cargo assembly 510 has been disengaged and dropped from the aircraft spine 120. In a preferred embodiment, the modular units 510A, B, C are disengaged from one another by a timed explosive which detonates to sever the mounts coupling the modular units 510A, B, C together. The modular units 510A, B, C are each further equipped with one or a plurality of parachutes 700 which deploy after the modular units 510A, B, C have been disengaged from one another. FIG. 6 depicts an alternative embodiment in which a single parabolic parachute 800 attached to a modular cargo unit 900 via lines 804 and risers 806.

While FIGS. 5A-C depict the delivery of the cargo assembly 510 while the aircraft 100A is in flight, it is understood that the cargo assembly 510 may also be delivered when the aircraft 100A is grounded. In accordance with this embodiment, once the aircraft 100A loaded with the cargo assembly 510 lands at the desired location, the aft fairing 130 and the lower fairing doors 164 may open and the mounts may disengage the cargo assembly 510. The cargo assembly 510 may drop to the ground and the aircraft 100A may proceed forward to clear the cargo assembly 510. The unloaded aircraft 100A may then be loaded with another cargo assembly or take-off to the next desired location.

In an yet another alternative embodiment, the cargo assembly may remain mounted onto the spine with only the

contents of the cargo assembly being released. Such an embodiment is particularly useful in military applications, as shown in FIGS. 7 through 10.

FIGS. 7 and 9 show an aircraft embodiment 100B in which the side fairing panels 160 further comprise a plurality of subpanels 170 which are retractable to expose a portion of the cargo assembly 400 mounted onto the spine 120. The cargo assembly 400 may be configured to house weapons and ammunition. To that end, the cargo assembly 400 may comprise a combination of modular frames 410A, B, C and modular weapon bays 420A, B, C coupled together by attachments 450. The structural frames 410A, B, C may be configured to house cargo 412 and fuel 414, while the modular weapon bays 420A, B, C may house various types of weapons, ammunition or artillery. As shown in FIG. 9, subpanel 175 is retracted while the aircraft 100B is in flight to allow firing of ammunition 177 from a weapon that is housed in an exposed modular weapon bay.

FIG. 8A-B depict another embodiment of a cargo assembly comprising a plurality of modular weapon bays 714, 716 housed within a plurality of structural frames 710A-F coupled together by attachments 750. Modular weapon bay 714 is laterally oriented such that ammunition may be fired when the corresponding subpanel 170 is retracted. Similarly, modular weapon bay 716 is oriented downward towards the ground such that, when mounted onto the aircraft spine, ammunition is fired or dropped there from. One or more bladders 712 comprising fuel or other liquids may optionally be stored.

FIG. 10 shows an embodiment in which the bombs or ammunition 165 are dropped or fired through the opened lower fairing doors 164. Again, in such an embodiment, the cargo assembly may be used to house artillery from which ammunition 165 may be launched through the open lower fairing doors 165 while the aircraft 100B is in flight.

It is to be understood that the detailed description and specific examples, while indicating preferred embodiments of the present invention, are given by way of illustration and not limitation. Many changes and modifications within the scope of the present invention may be made without departing from the spirit thereof, and the invention includes all such modifications.

What is claimed is:

1. A system for loading and unloading a cargo assembly onto an aircraft, the system comprising:
 - an aircraft comprising
 - a forward portion;
 - an aft portion;
 - a spine disposed between the forward portion and the aft portion, the spine defining an upper external surface of the aircraft and a lower coupling surface;
 - a plurality of mounts attached to the lower coupling surface of the spine to structurally engage the cargo assembly onto the spine;
 - wherein the aircraft is configured such that an unobstructed passageway is provided between a ground surface and the spine during loading or unloading of the cargo assembly onto or from the spine, respectively; and
 - a deployable fairing attached to the front portion or the aft portion, the deployable fairing movable between a fixed position for flight and an open position, wherein access to the unobstructed passageway and the spine is provided when the deployable fairing is in the open position;

and
 a moveable platform for maneuvering the cargo assembly
 to and from a loading area underneath the spine.
 2. The system of claim 1, wherein the moveable platform
 maneuvers the cargo assembly to and from the spine via the
 unobstructed passageway.
 3. The system of claim 1, wherein the movable platform
 further comprises sensors for determining a location of the
 movable platform relative to the spine.
 4. The system of claim 1, wherein the moveable platform
 is configured to lift the cargo assembly onto the spine.
 5. The system of claim 4, wherein the aircraft spine and
 the movable platform each comprise means for determining
 a loading position of the movable platform relative to the
 spine prior to lifting the cargo assembly onto the spine for
 mounting thereon.
 6. A system for loading and unloading a cargo assembly
 onto
 an aircraft, the system comprising:
 an aircraft comprising
 a forward portion;
 an aft portion; and
 a cargo-loading portion disposed between the forward
 portion and the aft portion, the cargo-loading portion
 defining an upper external surface of the
 aircraft and a lower coupling surface; and
 a plurality of mounts attached to the lower coupling
 surface of the cargo-loading portion to structurally
 engage and suspend the cargo assembly from the
 cargo-loading portion; wherein
 the front portion or the aft portion comprises a
 deployable fairing, the deployable fairing mov-
 able between a fixed position for flight and an
 open position in which access to the cargo-loading
 portion is provided for loading the cargo assembly
 onto the cargo-loading portion; and
 a moveable platform for maneuvering the cargo assembly
 to and from the cargo-loading portion.
 7. The system of claim 6, wherein the moveable platform
 is configured to lift the cargo assembly onto the cargo-
 loading portion.
 8. The system of claim 7, wherein the deployable fairing
 is a removable fairing removably attached to the front
 portion or the aft portion.
 9. The system of claim 7, wherein the deployable fairing
 is a hinged fairing that is hingedly attached to the front
 portion or the aft portion, and rotatable between the fixed
 position and the open position.
 10. An aircraft for transporting a cargo assembly com-
 prising:
 a forward portion;
 an aft portion;
 a cargo-loading portion disposed between the forward
 portion and the aft portion, the cargo-loading portion

defining an upper external surface of the aircraft and a
 lower coupling surface; and
 a plurality of mounts attached to the lower coupling
 surface of the cargo-loading portion to structurally
 engage and suspend the cargo assembly from the cargo-
 loading portion;
 wherein the front portion or the aft portion comprises a
 deployable fairing, the deployable fairing movable
 between a fixed position for flight and an open
 position in which access to the cargo-loading portion
 is provided for loading the cargo assembly onto the
 cargo-loading portion when the deployable fairing is
 in the open position.
 11. The aircraft of claim 10, wherein the deployable
 fairing is a removable fairing removably attached to the
 front portion or the aft portion.
 12. The aircraft of claim 10, wherein the deployable
 fairing is a hinged fairing that is hingedly attached to the
 front portion or the aft portion, and rotatable between the
 fixed position and the open position.
 13. The aircraft of claim 10, wherein the forward portion
 comprises a forward fairing, and the aft portion comprises an
 aft fairing, the aft fairing comprising the deployable fairing.
 14. The aircraft of claim 13, further comprising lower
 fairing doors pivotally coupled to lateral sub-structures
 coupled to the forward fairing and the aft fairing.
 15. The aircraft of claim 13, further comprising side
 fairing panels disposed between the forward fairing and the
 aft fairing.
 16. The aircraft of claim 15, wherein the side fairing
 panels further comprise one or more subpanels, the one or
 more subpanels being retractable to expose a portion of the
 cargo assembly.
 17. The aircraft of claim 16, wherein the subpanels are
 retracted to expose the portion of the cargo assembly while
 the aircraft is in flight.
 18. The aircraft of claim 13, wherein the aft fairing
 comprises two halves pivotally coupled to corresponding
 sides of the aircraft.
 19. The aircraft of claim 18, wherein the two halves of the
 aft fairing are pivotally actuated in the open position to
 increase drag during landing of the aircraft.
 20. The aircraft of claim 10, wherein the plurality of
 mounts are actuated between an engage and a release
 position, wherein in the engage position, the mounts struc-
 turally engage the cargo assembly to the cargo-loading
 portion and wherein in the release position, the mounts
 disengage and release the cargo assembly from the cargo-
 loading portion.
 21. The aircraft of claim 20, wherein the plurality of
 mounts are actuated in a release position to disengage and
 release the cargo assembly from the cargo-loading portion
 while the aircraft is in flight.

* * * * *